

# ADJUSTABLE TAP and REAMER WRENCH

ART NO. 823





DUCTILE BODY  
STEEL HANDLE

DIE-CASTING BODY  
STEEL HANDLE

HIGH CLASS STANDARD CLASS

SKC NO.	CAPACITY (SIZE)		NOMINAL SIZE	LENGTH	NET WEIGHT
	HAND TAPS	PIPE TAPS			
0	1/16" TO 1/4"		1/4"	7"	100g
4	1/16 TO 3/8	1/8"	3/8	9	150
5	3/16 TO 1/2	1/8 TO 1/4"	1/2	11	250
6	1/4 TO 3/4	1/8 TO 3/8	3/4	15	500
7	3/8 TO 1	1/8 TO 3/4	1	19	1kg
7 1/2	5/8 TO 1 1/4	1/4 TO 1 1/8	1 1/4	31	3K600
8	3/4 TO 1 1/2	3/8 TO 1 1/4	1 1/2	40	5K650
10	7/8 TO 2	1 TO 2	2	45	5K980
22	1 TO 2 3/4	1 TO 2 1/2	2 3/4	50	6K540
24	1 3/4 TO 4	2 TO 3 1/2	4	75	11K250

<b>NEW EXCELLENT</b>	<b>NEW EXCELLENT</b>	<b>NEW EXCELLENT</b>																		
<b>DIE STOCK</b>	<b>TAP WRENCH</b>	<b>5 PC. Screw Extractor Set</b>																		
<b>Porte-File's res</b>	<b>Tourne-a gaicje</b>	<b>Jeu de 5 Extracteurs de Vis</b>																		
<b>Schneideisenhalter</b>	<b>Verstellbare Windeisen</b>	<b>5-teilig, Schraubenausdrehersatz</b>																		
S/NO. ET-39DS: ROUND DIE S/NO. ET-39HEX: HEXAGON DIE ADJUSTABLE GUIDE 1" O/D 1A/F	S/NO. ET-39TW	S/NO. ET-5V PLASTIC CASE																		
																				
<table border="1"> <thead> <tr> <th>CAPACITY INCH</th> <th>CAPACITY M/M</th> <th>N. W.</th> </tr> </thead> <tbody> <tr> <td>1"</td> <td>25 φ</td> <td>250g</td> </tr> </tbody> </table>	CAPACITY INCH	CAPACITY M/M	N. W.	1"	25 φ	250g	<table border="1"> <thead> <tr> <th>CAPACITY INCH</th> <th>CAPACITY M/M</th> <th>N. W.</th> </tr> </thead> <tbody> <tr> <td>1/8" ~ 1/2"</td> <td>M3 ~ M12</td> <td>250g</td> </tr> </tbody> </table>	CAPACITY INCH	CAPACITY M/M	N. W.	1/8" ~ 1/2"	M3 ~ M12	250g	<ul style="list-style-type: none"> <li>■ CHROME VANADIUM STEEL</li> <li>■ SPIRAL FINE FLUTE</li> </ul> <div style="border: 1px solid black; padding: 5px; margin-top: 10px;"> <p><b>INCLUDING:</b></p> <p>#1 FOR 3/16 TO 1/4 SCREW                  #2 FOR 1/4 TO 5/16 SCREW                  #3 FOR 5/16 TO 7/16 SCREW                  #4 FOR 7/16 TO 3/4 SCREW                  #5 FOR 3/16 TO 3/4 SCREW</p> <table border="1" style="width: 100%; margin-top: 5px;"> <thead> <tr> <th>PER CASE</th> <th>G. W.</th> <th>MEAS' T</th> </tr> </thead> <tbody> <tr> <td>20 doz.</td> <td>24kg</td> <td>1.1 CFT</td> </tr> </tbody> </table> </div>	PER CASE	G. W.	MEAS' T	20 doz.	24kg	1.1 CFT
CAPACITY INCH	CAPACITY M/M	N. W.																		
1"	25 φ	250g																		
CAPACITY INCH	CAPACITY M/M	N. W.																		
1/8" ~ 1/2"	M3 ~ M12	250g																		
PER CASE	G. W.	MEAS' T																		
20 doz.	24kg	1.1 CFT																		

# TAP HOLDER

ART NO.868

## ■ RATCHET TYPE



WITH 2 JAWS OF HARDENED AND TEMPERED STEEL  
ALL CHROME PLATED FINISH OR BLACK FINISH  
FOR "HEAVY DUTY OPERATION"

SKC NO.	CAPACITY (SIZE) HAND TYPIS	(SIZE)NO. DIA OF INCH	CAPACITY SIZE M/M TAPS	WEIGHT
R1	1/8" TO 3/8"	3/8"	M3 TO M10	220g
R2	7/32 TO 1/2	1/2	5 TO 12	300

## ■ SPRING TYPE



SKC NO.	CAPACITY SIZE HAND TAPS	SIZE DIA. OF INCH	CAPACITY SIZE M/M TAPS	WEIGHT
S1	1/16" TO 3/16"	3/16"	MITOM 5	80g
S2	5/32 TO 1/4	1/4	3TO 6	110
S3	3/16 TO 3/8	3/8	5TO 10	200
S4	1/4 TO 1/2	1/2	6TO 12	320

# 3PC. TAP HOLDER SET

VINYL KIT OR BLISTER PACK

ART NO.703



	NO.	CAPACITY (TAPS)	NET WEIGHT
"T" TYPE 3PCS. SET	T - 10	1/16" ~ 3/16"	30g
	T - 20	5/32 ~ 1/4	40
	T - 30	3/16 ~ 3/8	65
"T" TYPE	T - 40	1/4 ~ 1/2	150
G. P. TYPE 3PCS. SET	GP-100	1/16 ~ 3/16	70
	GP-200	5/32 ~ 1/4	80
	GP-300	3/16 ~ 3/8	90
G. P. TYPE	GP-400	1/4 ~ 1/2	200
PER CASE	G. W.	MEAS' T	
10 DOZ	30kg	1.1 CFT	CARTON

# STOCK FOR ROUND DIES STOCK FOR HEX DIES

ART NO.824

## Stock for Round Dies

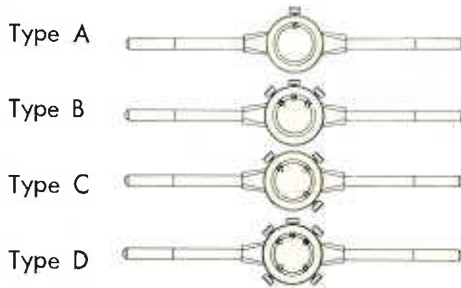

STEEL

DIE-CASTING BODY  
STEEL HANDLE

CAST-IRON BODY  
STEEL HANDLE

SKC NO.	Outside Diameter of Round Dies	Length			Net. Wt
		STEEL	DIE-CASTING BODY STEEL HANDLE	CAST-IRON BODY STEEL HANDLE	
S-1950	$\frac{5}{8}$ ( 15.8mm)	$7\frac{9}{32}$ (185mm)	DIE CASTING HANDLE $7\frac{15}{32}$ (190mm) $\text{Ø}8\frac{5}{16}$ (255) $\text{Ø}7\frac{3}{4}$ (187)		100(g)
S-1951	$\frac{13}{16}$ ( 20 mm)	$7\frac{9}{32}$ (185mm)			100(g)
S-1952	1 ( 25 mm)	$7\frac{9}{32}$ (185mm)			100(g)
S-1955	$1\frac{1}{2}$ ( 38 mm)	$12\frac{13}{64}$ (310mm)		12 (305mm)	12 ( 305mm)
S-1958	2 ( 50 mm)	$15\frac{3}{4}$ (400mm)	$14\frac{9}{16}$ (375mm)	$15\frac{23}{64}$ ( 390mm)	700(g)
S-1959	$2\frac{1}{4}$ ( 57 mm)			$18\frac{1}{2}$ ( 470mm)	1200(g)
S-1960	$2\frac{1}{2}$ ( 63 mm)			$21\frac{1}{16}$ ( 535mm)	1400(g)
S-1961	$2\frac{3}{4}$ ( 70 mm)			$21\frac{29}{64}$ ( 545mm)	1600(g)
S-1962	3 ( 75 mm)			$21\frac{27}{32}$ ( 555mm)	1800(g)
S-1963	4 (100 mm)			$35\frac{27}{64}$ ( 900mm)	4000(g)
S-1964	5 (127 mm)			$49\frac{7}{32}$ (1250mm)	7500(g)
S-1965	$1\frac{5}{8}$ ( 42 mm)			16 ( 400mm)	600(g)
S-1954	$1\frac{5}{16}$ ( 33 mm)			12 ( 305mm)	210(g)

## Stock for Hex Dies

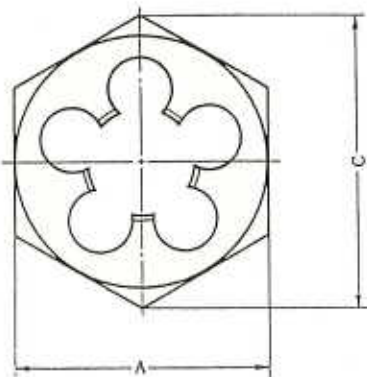

(Across Flats)



DIE-CASTING BODY  
STEEL HANDLE

SKC NO.	Across Hex Flats A	Length		Net. Wt.
		DIE-CASTING BODY STEEL HANDLE		
S-1977	1	$8\frac{1}{4}$ (210mm)		150g
S-1978	$1\frac{7}{16}$	12 (305mm)		295
S-1979	$1\frac{13}{16}$	$14\frac{9}{16}$ (375mm)		590

## Die Stocks Adjustable Guide



DIE-CASTING BODY  
STEEL HANDLE

	SKC NO.	Length	Net. Wt.
Outside Diameter of Round Dies 1inch	S-1980	250mm	220(g)
Across Hex Flats A 1inch	S-1981	250mm	220(g)

# 5 PC. SCREW EXTRACTOR SET

ART NO.705

ONE SET IN A VINYL KIT OR PLASTIC CASE



**45 CARBON STEEL 5 pieces a set**  
**HIGH CARBON STEEL**  
**CHROME VANADIUM STEEL**  
**SPIRAL FINE FLUTE**  
**SPIRAL COARSE FLUTE**  
**STRAIGHT FLUTE ( SQUARE TYPE)**

INCLUDING	#1 FOR	$\frac{3}{16}$	TO	$\frac{1}{4}$	SCREW
	#2 FOR	$\frac{1}{4}$	TO	$\frac{5}{16}$	SCREW
	#3 FOR	$\frac{5}{16}$	TO	$\frac{7}{16}$	SCREW
	#4 FOR	$\frac{7}{16}$	TO	$\frac{9}{16}$	SCREW
	#5 FOR	$\frac{9}{16}$	TO	$\frac{3}{4}$	SCREW

PER CASE	G.W.	MEAS' T	
20 doz	20kg	1.1CFT	CARTON

# SCREW EXTRACTOR and SET

ART NO.843



**SPIRAL FINE FLUTE**  
**SPIRAL COARSE FLUTE**  
**STRAIGHT FLUTE ( SQUARE TYPE)**

Used for extraction the remained screw easily without giving any damage to the screw threads when bolt or screw happens to break inside the screw hole and it is applied for detaching small coupling of iron pipe and extraction broken pipe in the screw hole of valve etc, .....

NO. OF COMBI-NATION SET	NO. OF CONTENTS	NOS	WEIGHT	REMARK
1815	801.2.3.4.5	5 Ea	200g	
1816	801.2.3.4.5.6	6	370	
1817	804.5.6	3	320	With H. S. S.
1818	806.7.8.9	4	1,800	Drill
1820	801.2.3.4.5.6	6	820	
1821	805.5 $\frac{1}{4}$ .6 $\frac{3}{8}$ .7 $\frac{1}{2}$ .	4	966	
1822	805.5 $\frac{1}{4}$ .6 $\frac{3}{8}$ .7 $\frac{1}{2}$ .8.9	6	2,400	earth 2 pcs
1829	801.2.3.4.5.6	12	750	With Stand
1830	801.2.3.4.5.5 $\frac{1}{4}$ .6	7	440	Case

NO. 1830—SKC With Special Standard (With details into earth packing)

EXTRACTOR NUMBER	DIMENSIONS—INCHES				SIZE DRILL TO USE Inches	FOR SCREWS AND BOLTS, SIZES Inches	FOR PIPE SIZES Inches	WEIGHT
	Diameter Small End	Diameter Large End	Length of Thread	Length Overall				
1	$\frac{1}{16}$	$\frac{1}{8}$	$\frac{1}{2}$	2	$\frac{5}{64}$	$\frac{3}{16}$ — $\frac{1}{4}$		5g
2	$\frac{3}{32}$	$\frac{13}{64}$	$\frac{7}{8}$	2 $\frac{3}{8}$	$\frac{7}{64}$	$\frac{1}{4}$ — $\frac{5}{16}$		10
3	$\frac{1}{8}$	$\frac{1}{4}$	1	2 $\frac{11}{16}$	$\frac{5}{32}$	$\frac{5}{16}$ — $\frac{7}{16}$		18
4	$\frac{3}{16}$	$\frac{11}{32}$	1 $\frac{1}{4}$	3	$\frac{1}{4}$	$\frac{7}{16}$ — $\frac{9}{16}$		30
5	$\frac{1}{4}$	$\frac{7}{16}$	1 $\frac{1}{2}$	3 $\frac{3}{8}$	$\frac{17}{64}$	$\frac{9}{16}$ — $\frac{3}{4}$	$\frac{1}{8}$	45
5 $\frac{1}{4}$	$\frac{11}{32}$	$\frac{17}{32}$	1 $\frac{1}{2}$	3 $\frac{3}{8}$	$\frac{23}{64}$	$\frac{11}{16}$ — $\frac{15}{16}$	$\frac{1}{4}$	80
6	$\frac{3}{8}$	$\frac{19}{32}$	1 $\frac{3}{4}$	3 $\frac{3}{4}$	$\frac{13}{32}$	$\frac{3}{4}$ — 1	105	105
6 $\frac{3}{8}$	$\frac{15}{32}$	$\frac{11}{16}$	1 $\frac{11}{16}$	3 $\frac{3}{4}$	$\frac{31}{64}$	$\frac{15}{16}$ — 1 $\frac{1}{8}$	$\frac{3}{8}$	150
7	$\frac{1}{2}$	$\frac{25}{32}$	2 $\frac{1}{4}$	4 $\frac{1}{8}$	$\frac{17}{32}$	1 — 1 $\frac{3}{8}$		190
7 $\frac{1}{2}$	$\frac{19}{32}$	$\frac{7}{8}$	2 $\frac{1}{4}$	4 $\frac{1}{8}$	$\frac{39}{64}$	1 $\frac{1}{8}$ — 1 $\frac{1}{2}$	$\frac{1}{2}$	220
8	$\frac{3}{4}$	1 $\frac{1}{32}$	2 $\frac{1}{4}$	4 $\frac{3}{8}$	$\frac{13}{16}$	1 $\frac{3}{8}$ — 1 $\frac{3}{4}$	$\frac{3}{4}$	370
9	1	1 $\frac{9}{32}$	2 $\frac{1}{4}$	4 $\frac{5}{8}$	1 $\frac{1}{16}$	1 $\frac{3}{4}$ — 2 $\frac{1}{8}$	1	580
10	1 $\frac{3}{4}$	1 $\frac{9}{16}$	2 $\frac{1}{2}$	5	1 $\frac{5}{16}$	2 $\frac{1}{8}$ — 2 $\frac{1}{2}$	1 $\frac{1}{4}$	1000
11	1 $\frac{1}{2}$	1 $\frac{7}{8}$	3	5 $\frac{5}{8}$	1 $\frac{9}{16}$	2 $\frac{1}{2}$ — 3	1 $\frac{1}{2}$	1500
12	1 $\frac{27}{32}$	2 $\frac{9}{32}$	3 $\frac{1}{2}$	6 $\frac{1}{4}$	1 $\frac{15}{16}$	3 — 3 $\frac{1}{2}$	2	2600

# 6 PC. TAP and TAP HOLDER SET

ART NO.706

ONE SET IN A VINYL KIT OR BLISTER PACK

**TUNGSTEN STEEL  
CARBON STEEL  
G.P TYPE HOLDER**

**"T"TYPE HOLDER**



THREAD	BSW	UNC	METRIC	UNF (SAE)	BSW
CUTTING	1/8" x 40	6 -32	M3 x 0.5	1/8" x 44	1/8" x 40
SIZE	5/32 x 32	8 -32	4 x 0.7	5/32 x 36	5/32 x 32
ONE	3/16 x 24	10 -32	5 x 0.8	3/16 x 32	3/16 x 24
PLUG	7/32 x 24	3/16-24	6 x 1.0	7/32 x 28	1/4 x 20
TAP	1/4 x 20	1/4 -20	8 x 1.25	1/4 x 28	5/16 x 18
OLDER	"T"	"T"	"T"	"T"	"T"
HOLDER	GP	GP	GP	GP	GP
W T PER P C	120g	120g	150g	125g	150g
	PER CASE	G. W.	MEAS' T		
"T" TYPE	20DOZ	20kg	1.1CFT		CARTON
G.P. TYPE	10DOZ	20kg	1.1CFT		CARTON

# 7 PC. TAP and TAP HOLDER SET

ART NO.717

ONE SET IN A VINYL KIT OR BLISTER PACK

**TUNGSTEN STEEL  
CARBON STEEL**

**BLISTER PACK AVAILABLE**

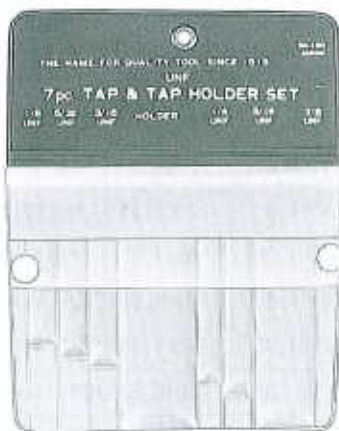

THREAD	METRIC	BSW
CUTTING	M 3 x 0.5	1/8" W40
SIZE	4 x 0.7	5/32 W32
ONE PLUG	5 x 0.8	3/16 W20
TAP	6 x 1.0	1/4 W20
	8 x 1.25	5/16 W18
	10 x 1.50	3/8 W16
TAP HOLDER	NO. 3	NO. 3
WEIGHT	185g	185g
PER CASE	G. W.	MEAS' T
10DOZ	20kg	1.1CFT
		CARTON

# 8 PC. TAP and ADJUSTABLE TAP WRENCH SET

ONE SET IN A VINYL KIT

ART NO.866

**ALLOY STEEL**  
**CARBON STEEL**

BLISTER PACK AVAILABLE



THREAD	METRIC	METRIC	BSW	UNC	UNF(SAE)
CUTTING	M 3×0.5	M 5×0.8	1/8" W40	# 6-32	1/8" NF44
SIZE	4×0.7	6×1.0	3/16 W24	# 8-32	3/16 NF32
	5×0.8	7×1.0	1/4 W20	#10-24	1/4 NF28
ONE	6×1.0	8×1.25	5/16 W18	1/4-20	5/16 NF24
PLUG	8×1.25	9×1.25	3/8 W16	5/16-18	3/8 NF24
TAP	10×1.50	10×1.50	7/16 W14	3/8-16	7/16 NF20
	12×1.75	12×1.75	1/2 W12	1/2-13	1/2 NF20
1 PC. TAP WRENCH					
CONTENTS PER CARTON.				G.W.	CFT
60 SETS				17kg	0.7

# 8 PC. DIE and DIE STOCK SET

ONE SET IN A VINYL KIT OR BLISTER PACK

ART NO.867

BLISTER PACK AVAILABLE

**ALLOY STEEL**  
**CARBON STEEL**

- SOLID ROUND DIE TYPE
- ADJUSTABLE ROUND SPLIT DIE TYPE
- 5 SCREW ROUND DIE TYPE

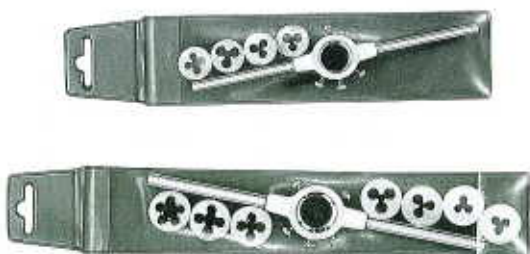

THREAD	METRIC	METRIC	BSW	UNC	UNF(SAE)
CUTTING	M 3×0.5	M 5×0.8	1/8" W40	# 6-32	1/8" NF44
SIZE	4×0.7	6×1.0	3/16 W24	# 8-32	3/16 NF32
	5×0.8	7×1.0	1/4 W20	#10-24	1/4 NF28
ONE	6×1.0	8×1.25	5/16 W18	1/4-20	5/16 NF24
ROUND	8×1.25	9×1.25	3/8 W16	5/16-18	3/8 NF24
DIE	10×1.50	10×1.50	7/16 W14	3/8-16	7/16 NF20
1" O/D	12×1.75	12×1.75	1/2 W12	1/2-13	1/2 NF20
1PC. — DIE STOCK (1" O/D)					
CONTENTS PER CARTON				G.W.	CFT
60 SETS				16kg	0.6